

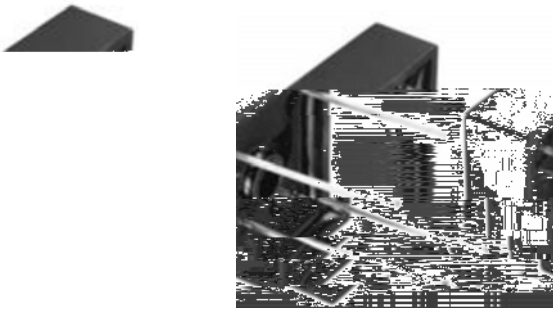

Bridge Rectifiers



Features

High efficiency
Low forward voltage drop
Low reverse leakage current
High surge current capability
High reliability

Typical Applications

Power supplies
Motor drives
Battery chargers
Inverters
Switching power supplies

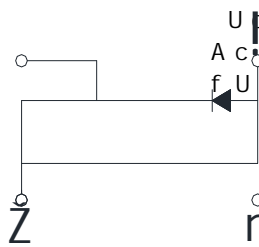

Terminals

Terminal 1: Cathode
Terminal 2: Anode
Terminal 3: Cathode
Terminal 4: Anode

Maximum Ratings

| PARAMETER | SYMBOL | UNIT | BR35005 | BR3501 | BR3502 | BR3504 | BR3506 | BR3508 | BR3510 |
|-------------------------------------|-----------|------|------------|------------|------------|------------|------------|------------|------------|
| Peak Repetitive Reverse Voltage | V_{RRM} | V | 60 | 60 | 60 | 60 | 60 | 60 | 60 |
| Peak Non-Repetitive Reverse Voltage | V_{RSM} | V | 60 | 60 | 60 | 60 | 60 | 60 | 60 |
| Peak Forward Current | I_{FM} | A | 1.0 | 1.0 | 1.0 | 1.0 | 1.0 | 1.0 | 1.0 |
| Peak Forward Surge Current | I_{FSM} | A | 10 | 10 | 10 | 10 | 10 | 10 | 10 |
| Average Forward Current | I_{AV} | A | 0.5 | 0.5 | 0.5 | 0.5 | 0.5 | 0.5 | 0.5 |
| Peak Reverse Current | I_{RM} | mA | 5 | 5 | 5 | 5 | 5 | 5 | 5 |
| Peak Reverse Surge Current | I_{RSM} | mA | 50 | 50 | 50 | 50 | 50 | 50 | 50 |
| Forward Voltage Drop | V_{DF} | V | 0.8 | 0.8 | 0.8 | 0.8 | 0.8 | 0.8 | 0.8 |
| Reverse Leakage Current | I_{RL} | mA | 5 | 5 | 5 | 5 | 5 | 5 | 5 |
| Power Dissipation | P_D | W | 0.5 | 0.5 | 0.5 | 0.5 | 0.5 | 0.5 | 0.5 |
| Operating Temperature Range | T_{op} | °C | -40 to 100 | -40 to 100 | -40 to 100 | -40 to 100 | -40 to 100 | -40 to 100 | -40 to 100 |
| Storage Temperature Range | T_{stg} | °C | -40 to 100 | -40 to 100 | -40 to 100 | -40 to 100 | -40 to 100 | -40 to 100 | -40 to 100 |



BR35005(W) THRU BR3510(W)

Electrical Characteristics

| PARAMETER | SYMBOL | UNIT | TEST CONDITIONS | BR35005 | BR3501 | BR3502 | BR3504 | BR3506 | BR3508 | BR3510 |
|-----------|--------|------|-----------------|---------|--------|--------|--------|--------|--------|--------|
| ... | ... | ... | ... | ... | ... | ... | ... | ... | ... | ... |
| ... | ... | ... | ... | ... | ... | ... | ... | ... | ... | ... |
| ... | ... | ... | ... | ... | ... | ... | ... | ... | ... | ... |

Thermal Characteristics

| PARAMETER | SYMBOL | UNIT | BR35005 | BR3501 | BR3502 | BR3504 | BR3506 | BR3508 | BR3510 |
|-----------|--------|------|---------|--------|--------|--------|--------|--------|--------|
| ... | ... | ... | ... | ... | ... | ... | ... | ... | ... |

Ordering Information (Example)

| PREFERRED P/N | PACKAGE CODE | UNIT WEIGHT (g) |
|---------------|--------------|-----------------|
| | | |

& # (



BR35005(W) THRU BR3510(W)

Outline Dimensions

6 F ! K

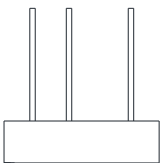
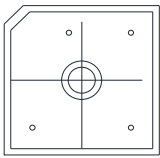

6 F

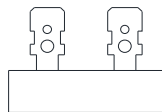
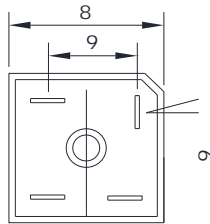

| BR-W | | |
|------|----------|----------|
| Dim | Min | Max |
| 5 | & , " & | & , " , |
| 6 | % + " % | % - " % |
| 7 | % \$ " (| % & " (|
| 8 | \$ " -) | % " \$) |
| 9 | % \$ " , | % % " & |
| : | ' \$ | # |
| ; | (") |) ") |

| BR | | |
|-----|----------|-----------|
| Dim | Min | Max |
| 5 | & , " & | & , " , |
| 6 | %) " ' . | % + " ' . |
| 7 | % + " % | % - " % |
| 8 | % ' " & | %) " & |
| 9 | \$ " +) | \$ " ,) |
| : | * " & | * " (|
| ; | & " ' . | & ") |
| < | % \$ " , | % % " & |
| = | % - | # |
| > | (") |) ") |

" # (.



BR35005(W) THRU BR3510(W)

Disclaimer

H \ Y] b Z c f a U h] c b ' d X f c V g i Y a b Y h b Y h X]] g b ' Z h c \ f] m g Y M U b f [Y r b W c Y i ' c M U b [^] Y ' 9 ` Y W h f c b] W ' H Y W \ b c f] [\ h ' h c ' a U _ Y ' W \ U b] [W Y g Z k c] f h h \ c Y ' g d b Y c W] d z f] c W U i h V h c g b ' X c] Z g ' h d ` U m Y X \ Y f Y] b ' h e ' X X g f j e j b Y c f ' c h \ Y f k] g Y " ...

H \ Y ' d f c X i W h `] g h Y X \ Y f Y] b] g ' X Y g Y] [b W X f h c c b V W i Y @ Y X d a h b h c e f X X Y U j f j W Y g h U b X ' b Y e i] d a Y b h ' c f ' X Y j] W Y g k \] W \ f Y e i X] h f \ Y ' a] U [' Z ' i ' b j W h] X c X] e f Y k V h d ' W n j k Y c f j X i t h U j b W k ' U i g a U b a Y X] W U `] b g h f i a Y b b g ' z e ' h f j d b g b b e H U U Y f f c m g z d b W W X a Y U U W \ !] f b Y U y / h c f ' W c b h f c ` ` Y f

(# (' .

G ! 7 \$ % + ' MU b [n \ c i ' MU b [W] H Y W \ b W h e e m] 7 c " z k @ h k X " & % m U b [^] F Y j " & " & z \$ % ! > i ` ! & (' .